

DRIVER Brian Thomas

DATE

TRACK GLARC

TRACTION

LOW MEDIUM HIGH

LAYOUT

SLOW MIXED FAST

ENGINE

TYPE Novarossi Mito WC

GLOW PLUG/FUEL PIPE/MANIFOLD Novarossi Flashpoint

2015 Short

CLUTCH SETTINGS

SHOE#/BELL# Yellow Kit

CLEARANCE(mm) / AXIALPLAY(mm) .6 0.1-0.2

SPRING#/ TENSION(mm) Kit 0.2

TYRES

CONTROLLED

FRONT BRAND REAR

LEFT RIGHT **Zac** LEFT RIGHT

32 32 SHORE 35 35

67 67 DIAMETER START 74 74

66 66 DIAMETER 5min 73 73

SHOCK ABSORBERS

FRONT REAR

PISTON kit PISTON kit

OIL 700 OIL 800

SPRING BLK SPRING WHT

ANTI ROLL BAR FRONT

2,2 2,3 2,4 2,5

ANTI ROLL BAR REAR

2,8 2,9 3,0

SERVO SAVER POSITION

FORWARD REARWARD

PINION 1st

15T 16T

PINION 2nd

19T 20T

SPUR 1st

48T 49T 50T

SPUR 2nd

45T 46T 47T

STEERING ROD POSITION

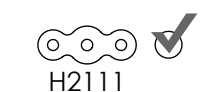
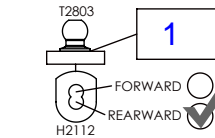

CASTER ANGLE (mm)

3

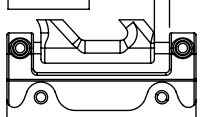

UPPER ARM POSITION

UP
 CENTER
 DOWN

CAMBER

LEFT 2 RIGHT 2

YES NO DISK

1 SHIM UNDER H0180(mm)

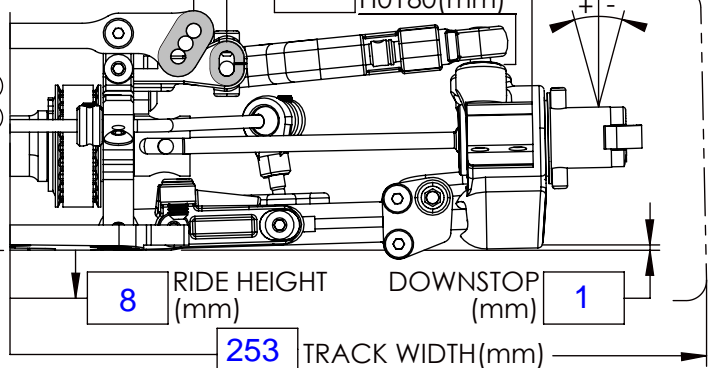

SHOCK/UPPER ROD POSITION

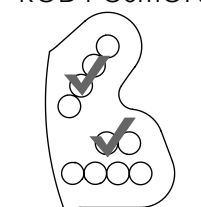

SHOCK POSITION H2115



LOWER ARM POSITION

UP
CENTER
DOWN

H0466G POSITION

SHIM(mm) 4

CAMBER

LEFT 3 RIGHT 3

YES NO DISK

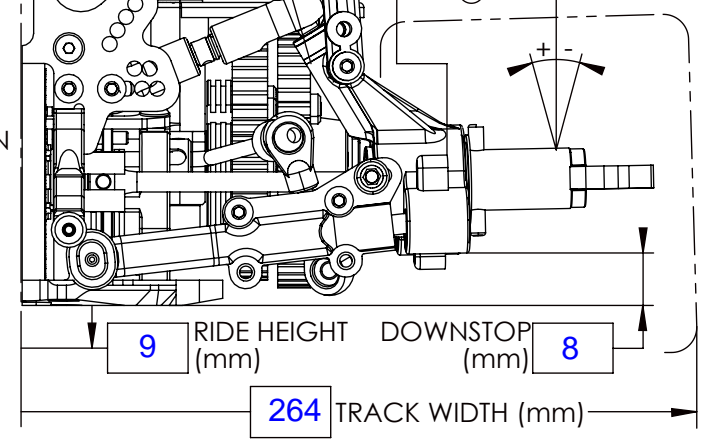

LEFT .5 RIGHT .5 FRONT TOE

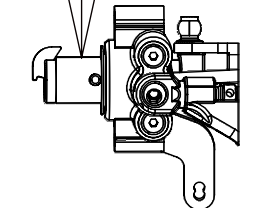

RADIOPATE FLEX

FIXED

OPEN

H2415 MOUNTED ON:



LEFT 2 RIGHT 2 REAR TOE

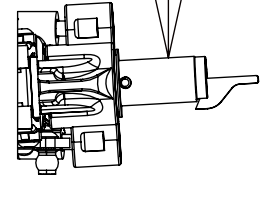

WEIGHT DISTRIBUTION

GR. 20

POSITION 60

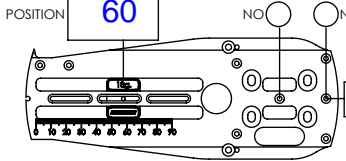

AERO/SETTING

BODY TYPE

PF 909

WING POSITION

6

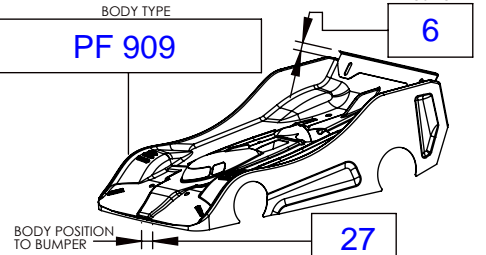

BODY POSITION TO BUMPER

27

NOTES: